



**STATE OF HAWAII
DEPARTMENT OF TRANSPORTATION
869 PUNCHBOWL STREET
HONOLULU, HAWAII 96813-5097**

Board of Land and
Natural Resources
State of Hawaii
Honolulu, Hawaii

CONSENT TO SUBLEASE OF LEASE NO. DOT-A-94-0007
FEDERAL EXPRESS CORPORATION TO
EVERGREEN AVIATION GROUND LOGISTICS ENTERPRISES, INC.
HONOLULU INTERNATIONAL AIRPORT

OAHU

LEGAL REFERENCE:

Section 171-36 (a) (6), Hawaii Revised Statutes

LESSEE:

Federal Express Corporation

SUBLESSEE:

Evergreen Aviation Ground Logistics Enterprises, Inc.

LOCATION OF SUBLEASE:

Honolulu International Airport (HIA), South Ramp

LAND STATUS OF SUBLEASE:

Governor's Executive Order 3201, Ceded Land – None

USE:

Airport Base Facility Area Lease

BLNR – Consent to Sublease of Lease No. DOT-A-94-0007
Federal Express Corporation to
Evergreen Aviation Ground Logistics Enterprises, Inc.
Page 2

ZONING:

State: Urban
County: Industrial (I-2)

LEASE TERM:

Twenty-seven (27) years, six (6) months, commencing on June 1, 1994 to
November 30, 2021

LEASE AREA:

Space No. 009-189, containing an area of 85,954 square feet, as shown on the attached
Exhibit A

SUBLEASE TERM:

No definite term but may be cancelled with 60 days' prior written notice

SUBLEASE AREA:

2,130 square feet of office and warehouse space

SUBLEASE RENT:

\$3,585.50 per month

REMARKS:

The State and the Lessee entered into Lease No. DOT-A-94-0007 dated February 27, 1995, for the exclusive use of certain premises for the purpose of constructing, maintaining, and operating an airport base facility area. The Lessee now desires to sublease a portion of the facility which it acquired through bankruptcy from Kitty Hawk International in 2002. The Department of Transportation (DOT) has reviewed the sublease and sublease rent and has determined that the sublessee's obligations are reasonable with no excess sublease profit to be gained by the lessee/sublessor.

BLNR – Consent to Sublease of Lease No. DOT-A-94-0007
Federal Express Corporation to
Evergreen Aviation Ground Logistics Enterprises, Inc.
Page 3

RECOMMENDATION:

That the Board authorize and grant the Consent to Sublease as hereinabove outlined so that the DOT may proceed with the sublease of Lease No. DOT-A-94-0007.

Respectfully submitted,



BARRY FUKUNAGA
Director of Transportation

APPROVED FOR SUBMITTAL:



ALLAN A. SMITH
Interim Chairperson and Member

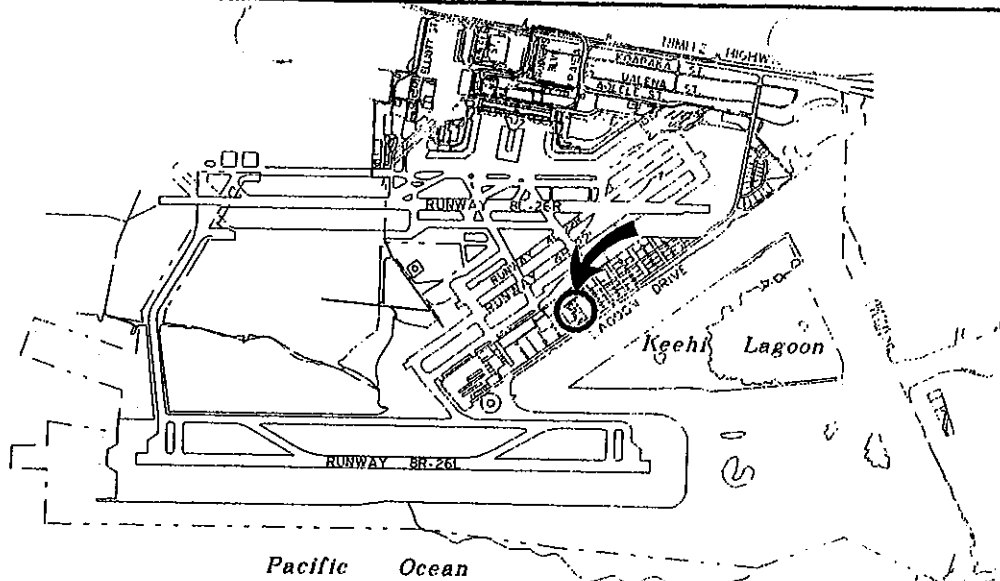

LOCATION PLAN

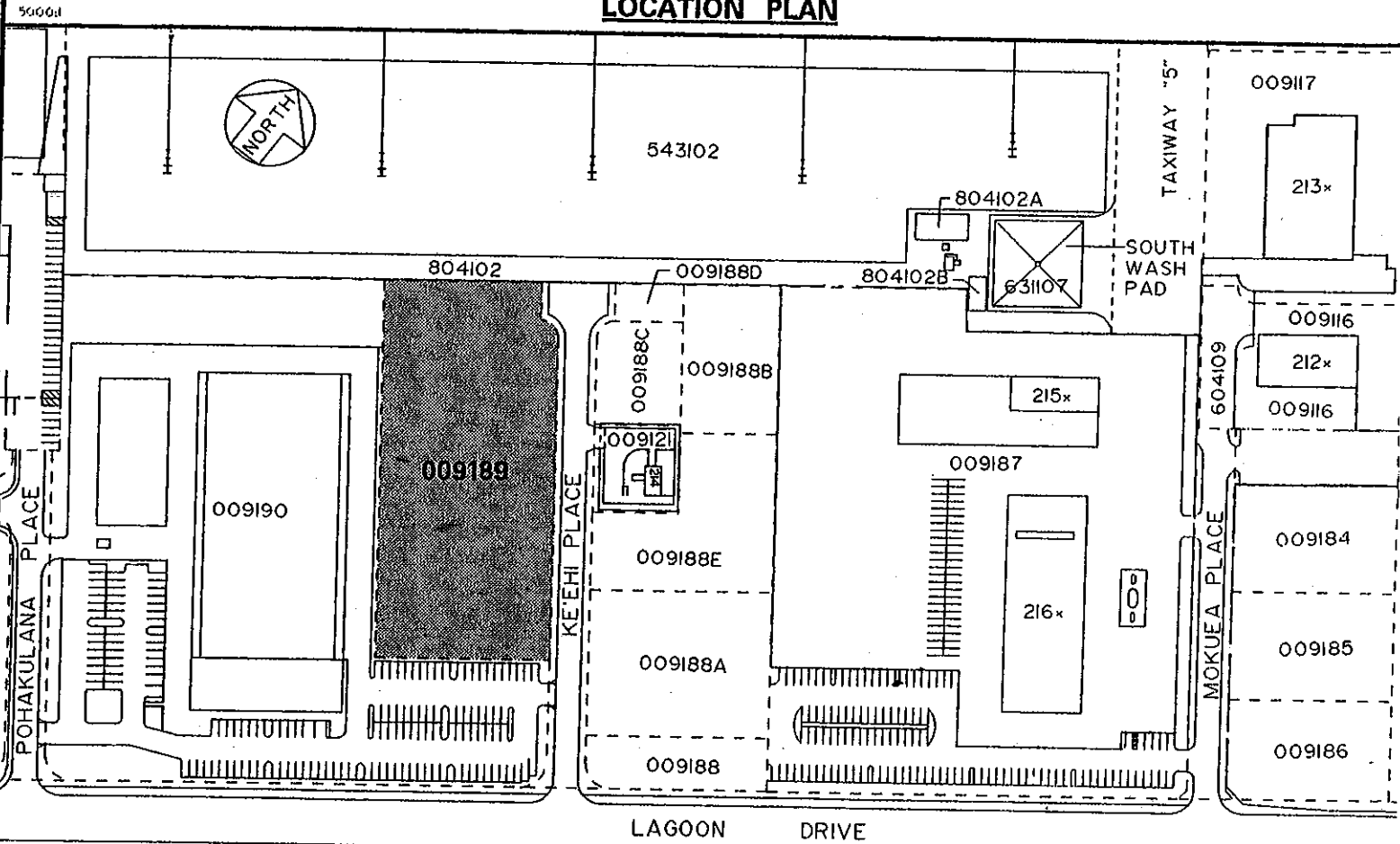

SCALE: 1"=200'

AREA/SPACE	SQ. FT.
009 189	85,954

DATE: MAY, 1994

EXHIBIT: **A**



Airports Division

FEDERAL EXPRESS CORP.

AIR CARGO LOTS
Base Facility

009189

PLAT 45

HONOLULU INTERNATIONAL AIRPORT